

MODEL L991 FLANGE

ANSI CLASS 125 / 150

The Model L991 Flange allows for direct connection of grooved system to ANSI class 125/150 flanged components.

SPECIFICATIONS

Sizes available:

50 mm - 300 mm / 2" ~ 12"

Working Pressure:

Up to 17 bar / 250 psi

Maximum working pressures are CWP (cold water pressure) or maximum allowed working pressure within the service temperature range of the gasket used in the coupling, based on standard wall or sch. 7/10/40 steel pipe, cut or roll-grooved to ANSI/AWWA C606-04 specifications.

These ratings may occasionally differ from maximum working pressures listed and/or approved by UL, ULC, and/or FM as testing conditions and test pipes differ. For performance data on other pipe schedules contact Lede.

Housing Coating:

Red Enamel

Housing material:

Ductile Iron conforming to ASTM A536 Gr. 65-45-12.

Gasket material:

EPDM (Silicon free) These gaskets have excellent self sealing capabilities and are designed to provide a leak tight seal.

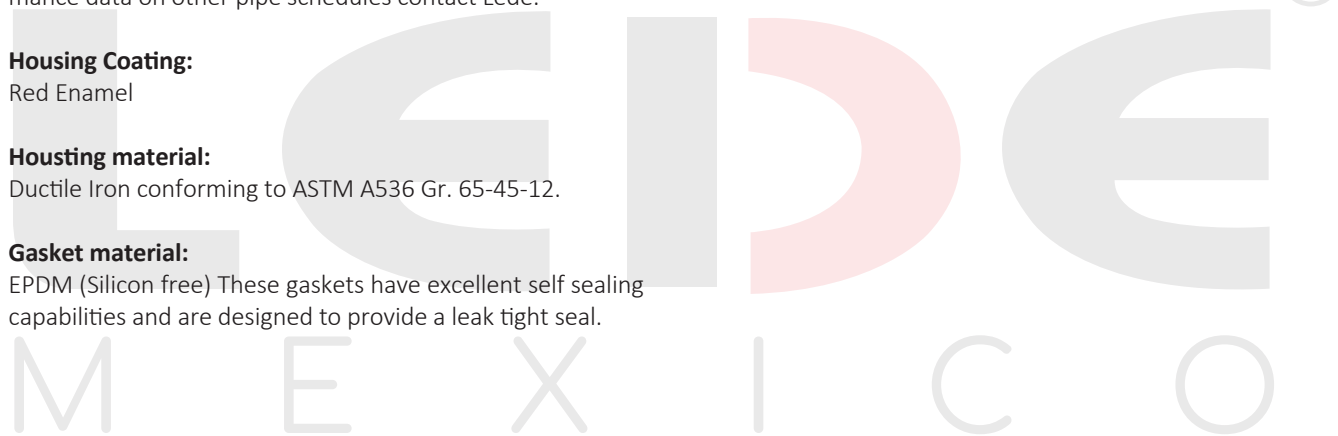

INTERNATIONAL APPROVAL



SUBMITTAL INFORMATION

PROJECT:	CONTRACTOR:	DATE:
ENGINEER:	SPECIFICATION REFERENCE:	SYSTEM TYPE:
LOCATIONS:	COMMENTS:	

MODEL L991 FLANGE

ANSI CLASS 125 / 150

DATA CHART

Lede couplings are identified by the nominal IPS pipe size in inches or nominal diameter of pipe (DN) in millimeters.

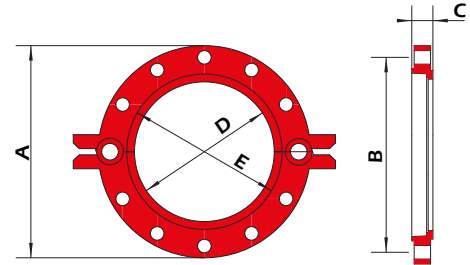

Nominal Size mm/in	Pipe O.D. mm/in	Max. Working Pressure Bar/PSI	Max. End Load KN/Lbs	Dimensions					Bolt	
				A mm/in	B mm/in	C mm/in	D mm/in	E mm/in	No.	Size mm/in
50	60.3	17	5.71	155	120.5	25	60	78	4	M16
2	2.375	250	1330	6.10	4.74	0.98	2.36	3.07		M16
65	73.0	17	8.37	180	140	25	73	93	4	M16
2 1/2	2.875	250	1950	7.09	5.51	0.98	2.87	3.66		M16
80	88.9	17	12.41	190	153	25	89	107	4	M16
3	3.500	250	2880	7.48	6.02	0.98	3.50	4.21		M16
100	114.3	17	20.51	230	191	25	114	131	8	M16
4	4.500	250	4770	9.06	7.52	0.98	4.49	5.16		M16
125	141.3	17	31.35	255	216	25	141	157	8	M20
5	5.563	250	7290	10.04	8.50	0.98	5.55	6.18		M20
150	168.3	17	44.47	280	241	25	168	185	8	M20
6	6.625	250	10340	11.02	9.49	0.98	6.61	7.28		M20
200	219.1	17	75.37	345	299	27	219	234	8	M20
8	8.625	250	17520	13.58	11.77	1.06	8.62	9.21		M20
250	273.0	17	164.71	405	362	30	273	294	12	M24
10	10.750	250	27210	15.94	14.25	1.18	10.75	11.57		M24
300	323.9	17	164.71	485	432	32	324	341	12	M24
12	12.75	250	38280	19.09	17.01	1.26	12.76	13.43		M24

Weights:

All weights are approximate and subject to change without notice.

Lede reserves the right to change or modify product designs, specifications and/or standard equipment without notice and without incurring obligation.

Sales:

Prices and Terms and Conditions of Sale are subject to change without notice.

Warranty:

We warrant all Lede products to be free from defects in materials and workmanship under normal conditions of use and service. For more information please contact LEDE.